

1 SECTION AT IAC WALL COLUMNS
SCALE: 1/4" = 1'-0"

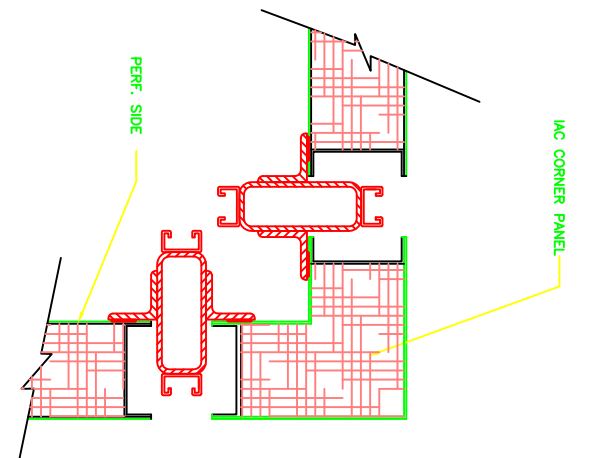

2 CORNER DETAIL
SCALE: 3/8" = 1'-0"

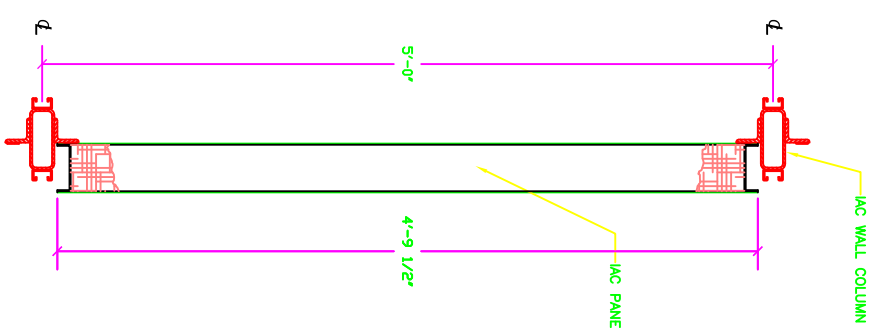

3 PANEL DETAIL
SCALE: 1 1/2" = 1'-0"

JAWS 1

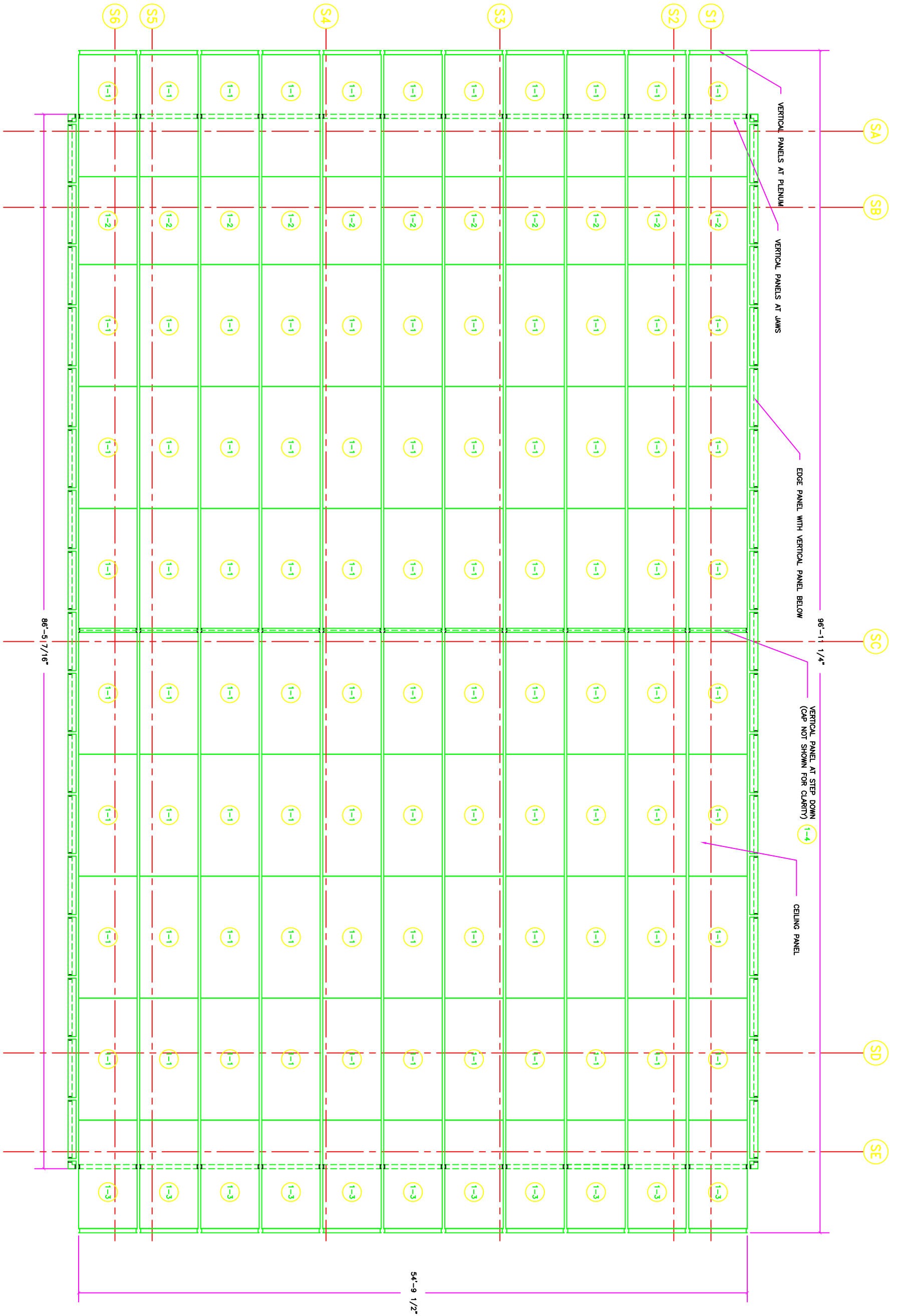

1 CEILING PANEL PLAN

SCALE: 1/4" = 1'-0"

JAWS 1

REVISIONS NO. DATE DESCRIPTION		TITLE CEILING PANEL PLAN OLYMPIC STUDIOS		NATIONAL BROADCASTING COMPANY, INC. OLYMPICS 3 Landmark Square, Suite 401 Stamford, CT 06901 203 964-8681 203 964-8688 Fax		PAC INDUSTRIAL ACOUSTICS COMPANY THE STANDARD OF SILENCE 1180 Commerce Avenue • Bronx, NY 10462 (718) 631-8000 9916-142-02		GEIGER ENGINEERS GEIGER GOSSEN HAMILTON LIAO ENGINEERS, P.C. 2 Executive Boulevard, Suite 410 Suffern, NY 10901-4164 (914) 368-3330 (914) 368-3330 Fax This document and its reproduction are copyright by GEIGER ENGINEERS and may not be reproduced or used in any manner without prior written permission from GEIGER ENGINEERS. Copyright © 1999	
DATE:	5/5/09	DRAWING NO.:	9916-142-2	DRAWN BY:	JOC	JOB NO.:	75-0644		
SCALE:	AS NOTED	CADD NO.:	9916-142-2						
CADD NO.:	75-0644								
SHEET NO.:	IAC-102								

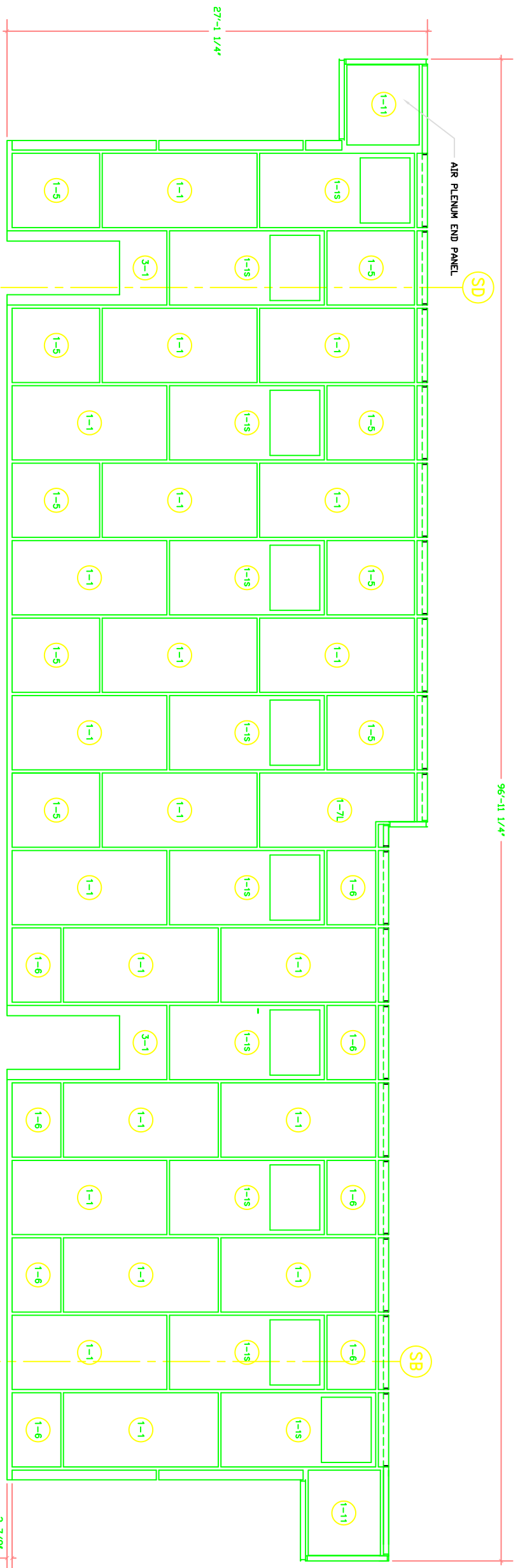

1 REAR ELEVATION

SCALE: 1/4" = 1'-0"

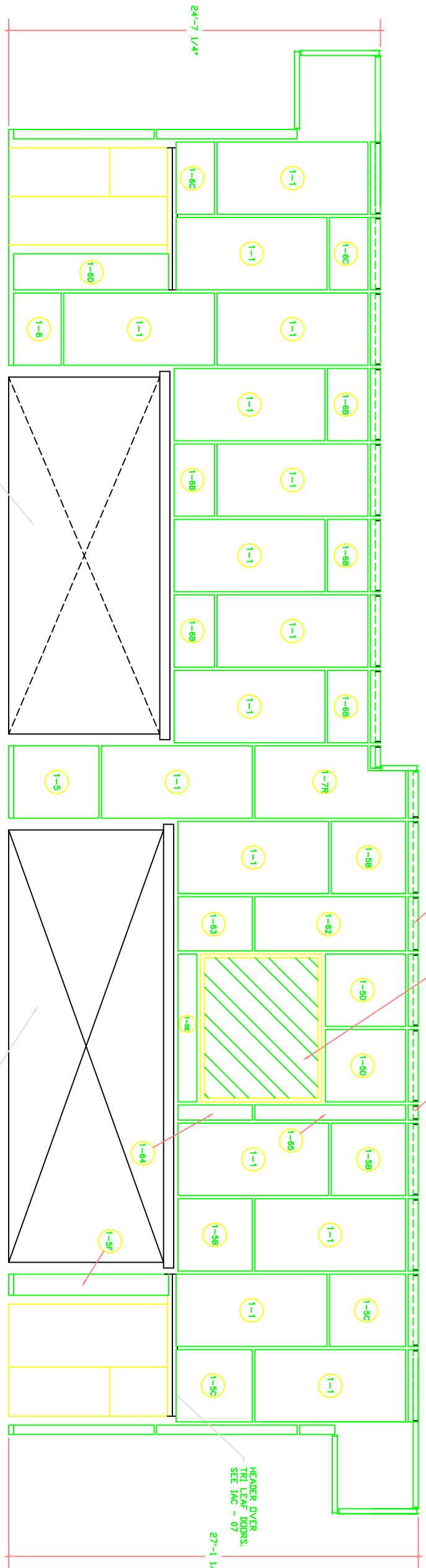

2 FRONT ELEVATION

SCALE: 1/4" = 1'-0"

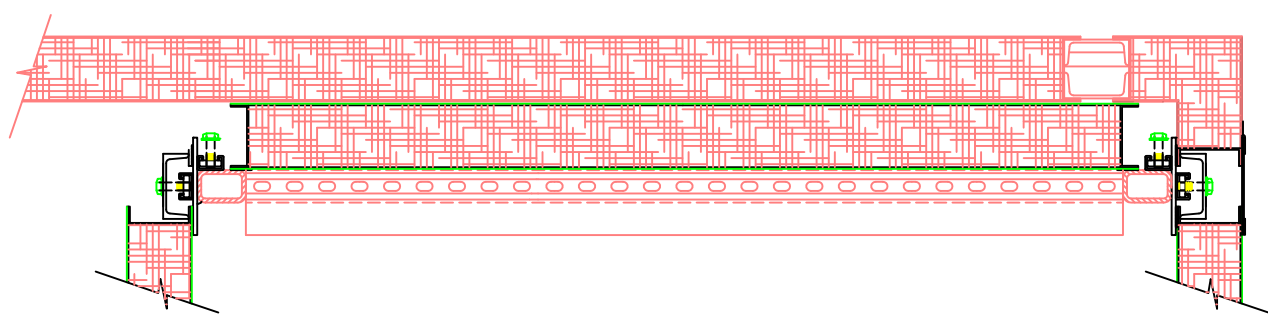

3 PLENUM END PANEL

SCALE: 2" = 1'-0"

REVISIONS NO. DATE DESCRIPTION 1 8/23/99 PROJECTION WINDOW MOVED		TITLE ELEVATIONS - 1 OLYMPIC STUDIOS		NBC NATIONAL BROADCASTING COMPANY, INC. OLYMPICS 3 Landmark Square, Suite 401 Stamford, CT 06901 203 964-8681 203 964-8686 Fax		Pac INDUSTRIAL ACOUSTICS COMPANY THE STANDARD OF SILENCE 1180 Commerce Avenue Bronx, NY 10462 (718) 631-8000 9916-142-03 DRAWN BY: JOC		GEIGER ENGINEERS GEIGER GOSSEN HAMILTON LIAO ENGINEERS, P.C. 2 Executive Boulevard, Suite 410 Suffern, NY 10901-4164 (914) 368-3330 (914) 368-3366 This document and its reproductions are copyright by GEIGER ENGINEERS and may not be reproduced or used in any manner without prior written permission from GEIGER ENGINEERS. Copyright © 1999	
---	--	--	--	---	--	---	--	---	--

JAWS 1

SHEET NO. IAC-103

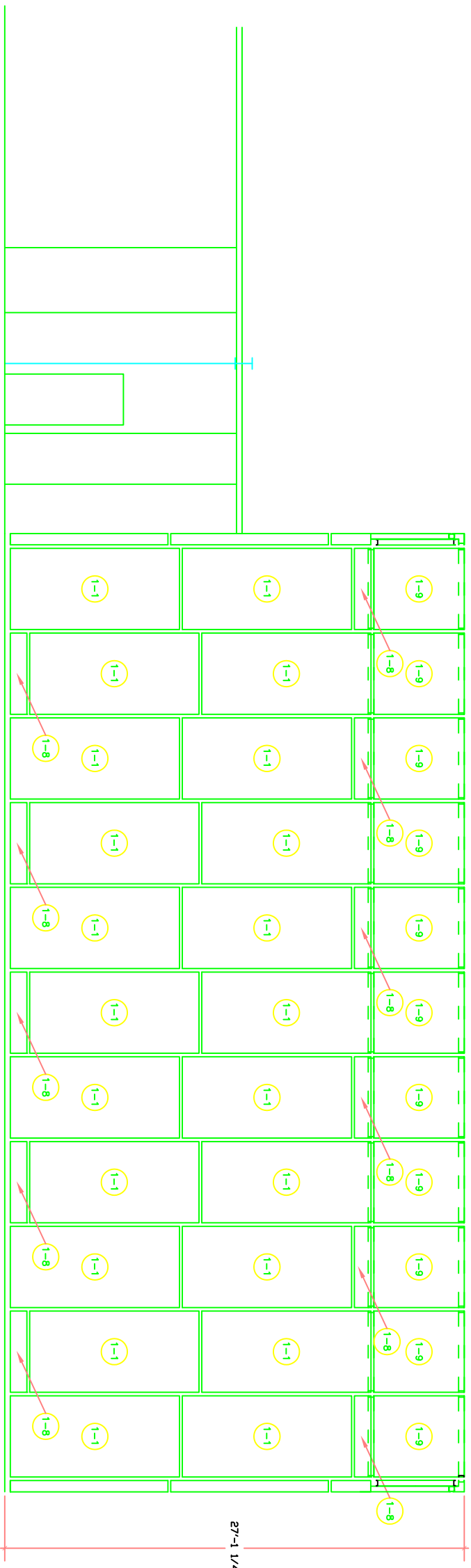

1 ELEVATION (AT STUDIO 1 WALL)
SCALE: 1/4" = 1'-0"

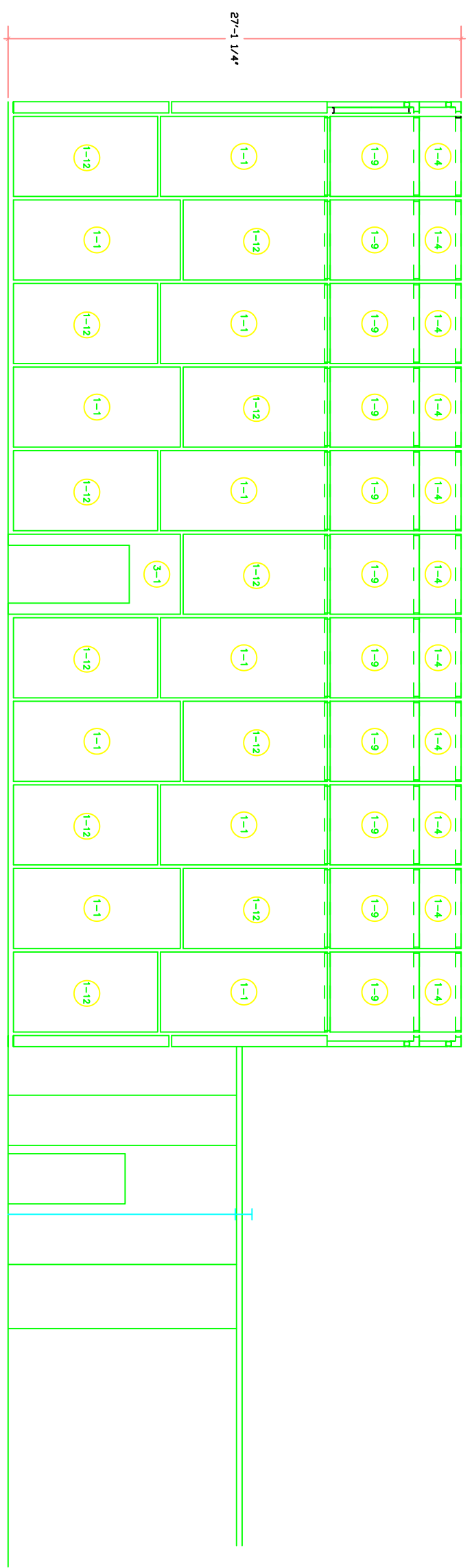

2 ELEVATION (AT RESEARCH WALL)
SCALE: 1/4" = 1'-0"

JAWS 1

REVISIONS NO. DATE DESCRIPTION	ELEVATIONS - 2 OLYMPIC STUDIOS	NATIONAL BROADCASTING COMPANY, INC. OLYMPICS 3 Landmark Square, Suite 401 Stamford, CT 06901 203 964-8681 203 964-8688 Fax	PAC INDUSTRIAL ACOUSTICS COMPANY THE STANDARD OF SILENCE 1180 Commerce Avenue • Bronx, NY 10462 (718) 631-8000 9916-142-04	GEIGER ENGINEERS GEIGER GOSSEN HAMILTON LIAO ENGINEERS, P.C. 2 Executive Boulevard, Suite 410 Suffern, NY 10901-4164 (914) 368-3330 FAX: (914) 368-3366 <small>This document and its reproductions are copyright by GEIGER ENGINEERS and may not be reproduced or used in any manner without prior written permission from GEIGER ENGINEERS. Copyright © Dale 1999</small>
	DATE: 5/5/09 SCALE: AS NOTED JOB NO. 75-0644 CADD NO. 9916-142-4 SHEET NO. IAC-104			

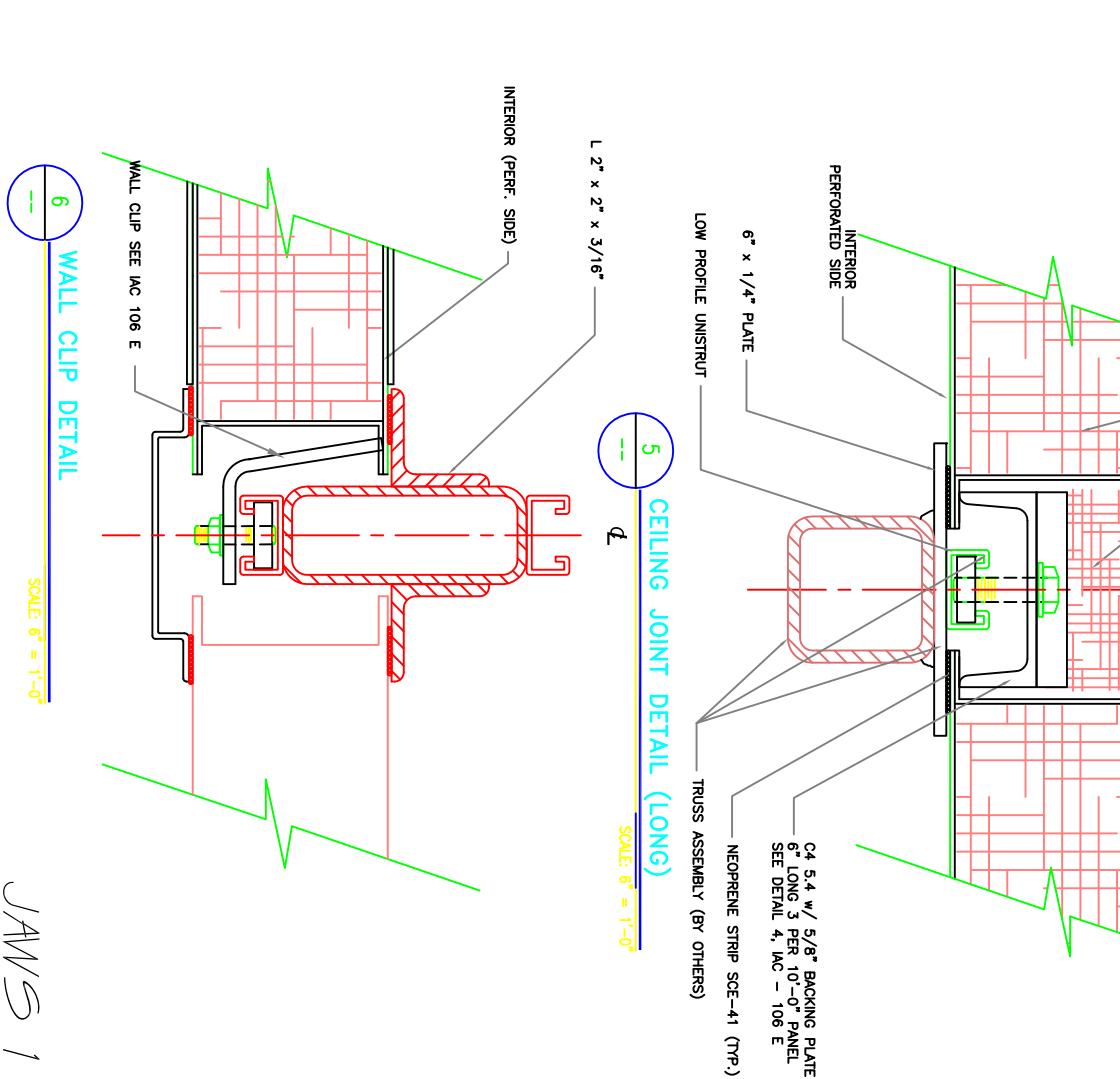
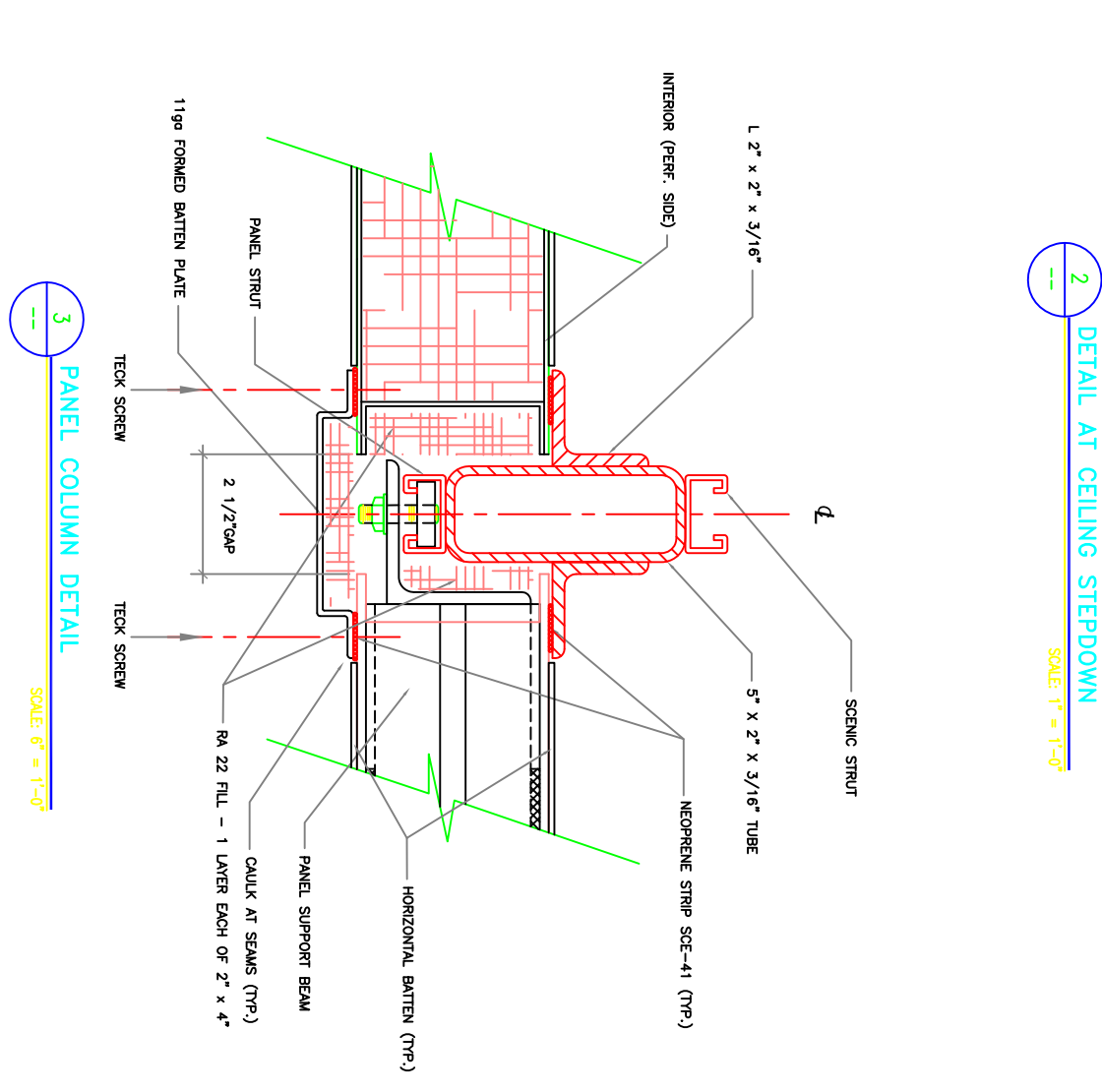
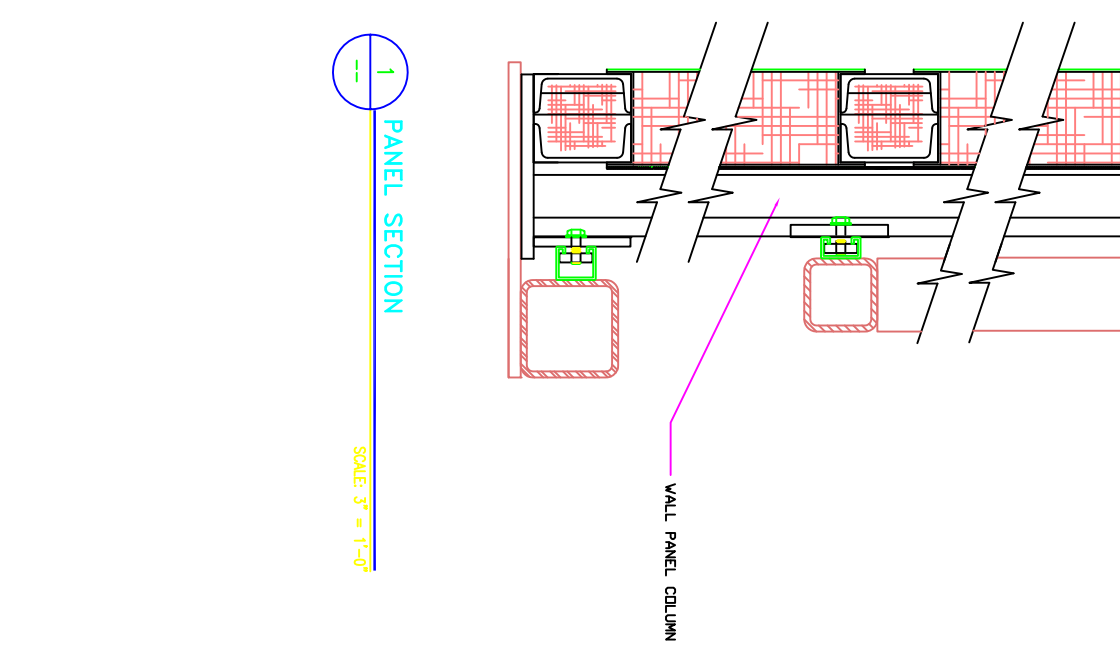
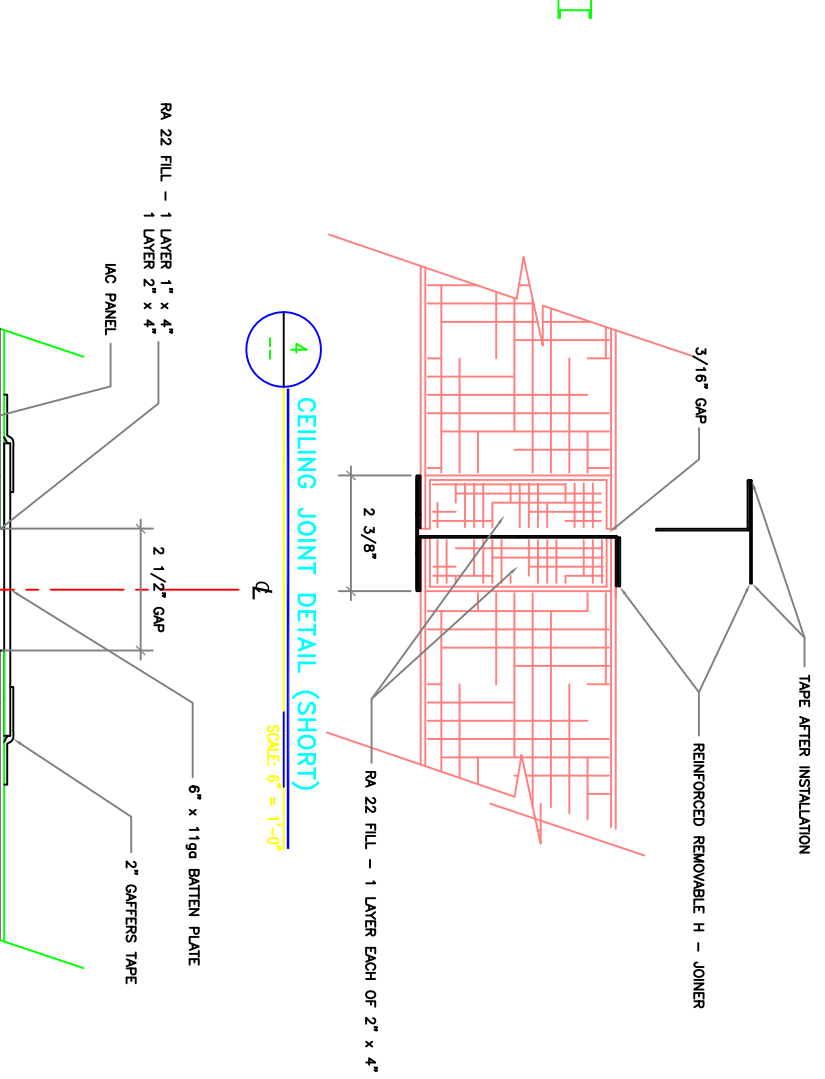
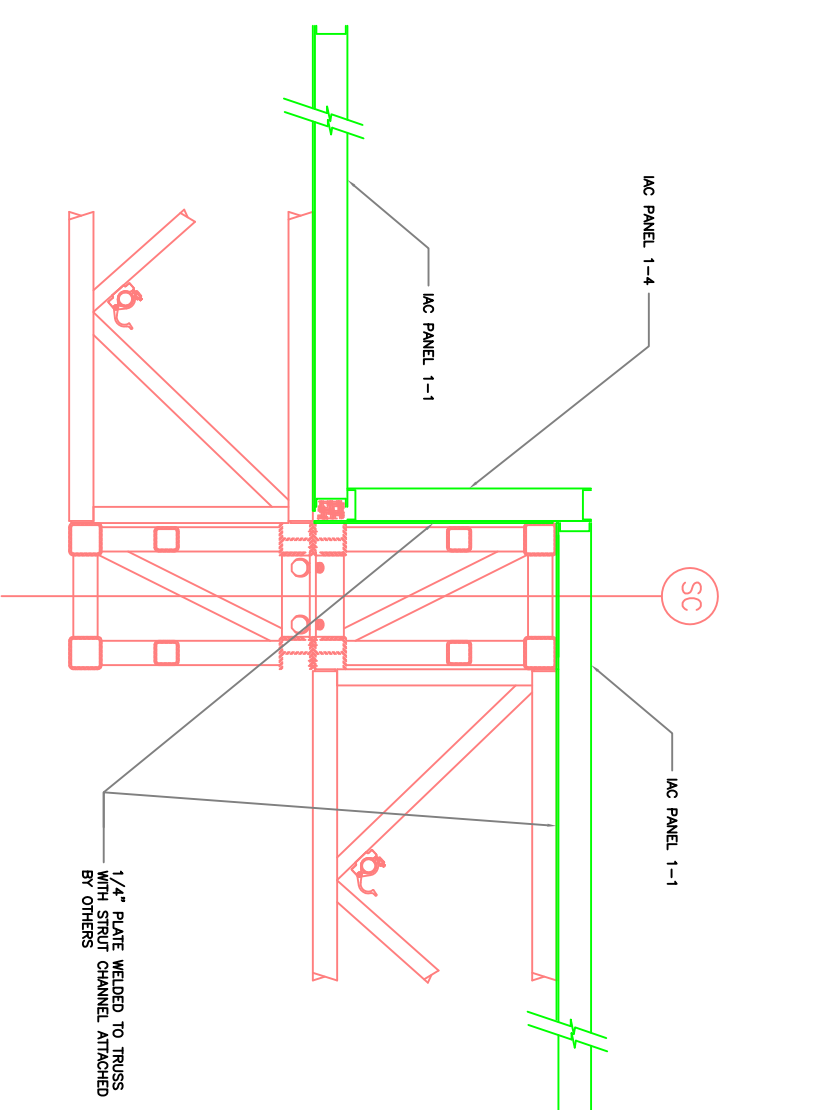
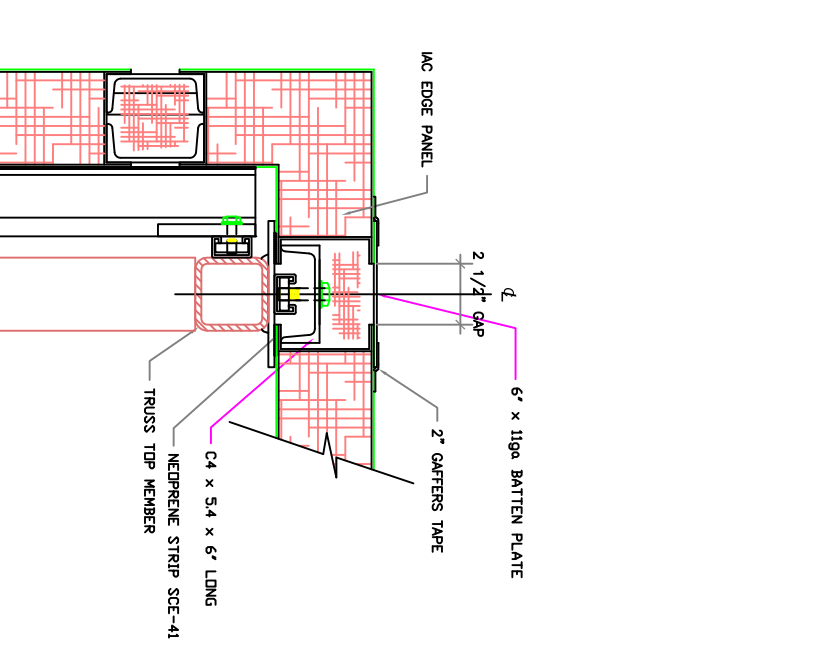

NO.	DATE	DESCRIPTION

IAC DETAILS - 1
OLYMPIC STUDIOS

NBC
NATIONAL BROADCASTING COMPANY, INC.
OLYMPICS
3 Landmark Square, Suite 401
Stamford, CT 06901
203 964-8681
203 964-8688 Fax

IAC INDUSTRIAL ACOUSTICS COMPANY
THE STANDARD OF SILENCE
(718) 831-8000
1180 Commerce Avenue - Bronx, NY 10462
FAX: (718) 863-1138
DRAWN BY: JOC
JOB No. 9916-142-05
75-0644

GEIGER ENGINEERS
GEIGER GOSSEN HAMILTON LIAO ENGINEERS, P.C.
2 Executive Boulevard, Suite 410
Suffern, NY 10901-4164
(914) 368-3330
FAX: (914) 368-3366
Copyright © 1999

JAWS 1

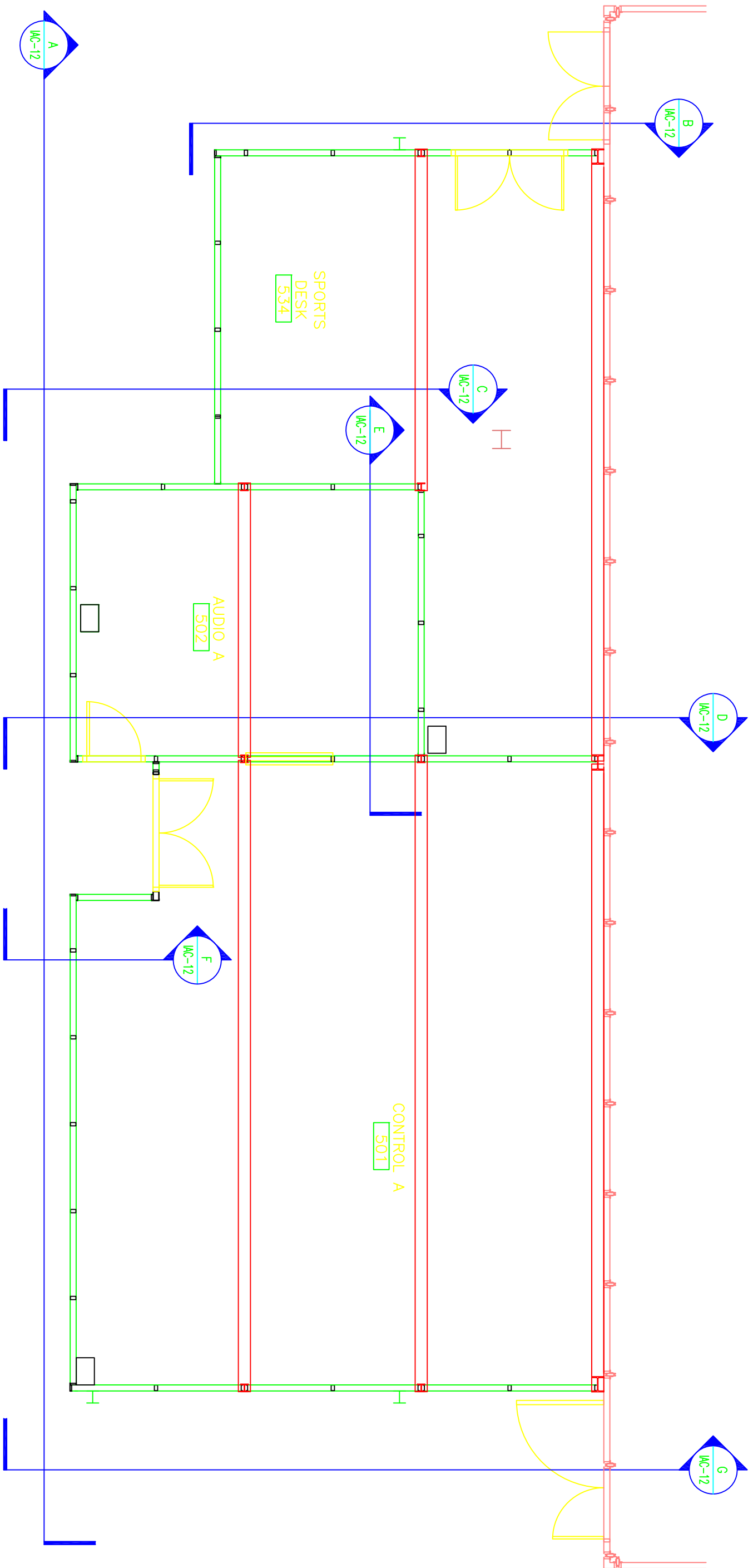

1 PLAN
SCALE: ---

JAWS 1

REVISIONS NO. DATE DESCRIPTION	MODULINE WALL PLAN OLYMPIC STUDIOS	NATIONAL BROADCASTING COMPANY, INC. OLYMPICS 3 Landmark Square, Suite 401 Stamford, CT 06901 203 964-8681 203 964-8688 Fax	INDUSTRIAL ACOUSTICS COMPANY 1180 Commerce Avenue - Bronx, NY 10462 THE STANDARD OF SILENCE (718) 631-8000 DRAWING NO. IAC-130 DRAWN BY: JOC JOB No. 75-0644	GEIGER ENGINEERS GEIGER GOSSEN HAMILTON LIAO ENGINEERS, P.C. 2 Executive Boulevard, Suite 410 Suffern, NY 10901-4164 (914) 368-3330 FAX: (914) 368-3366 <small>This document and its reproductions are copyright by GEIGER ENGINEERS and may not be reproduced or used in any manner without prior written permission from GEIGER ENGINEERS. Copyright © 1999</small>
	DATE: 6/11/99 SCALE: AS NOTED JOB NO. 75-0644 CADD NO. 9916-142-10 SHEET NO. IAC - 130			

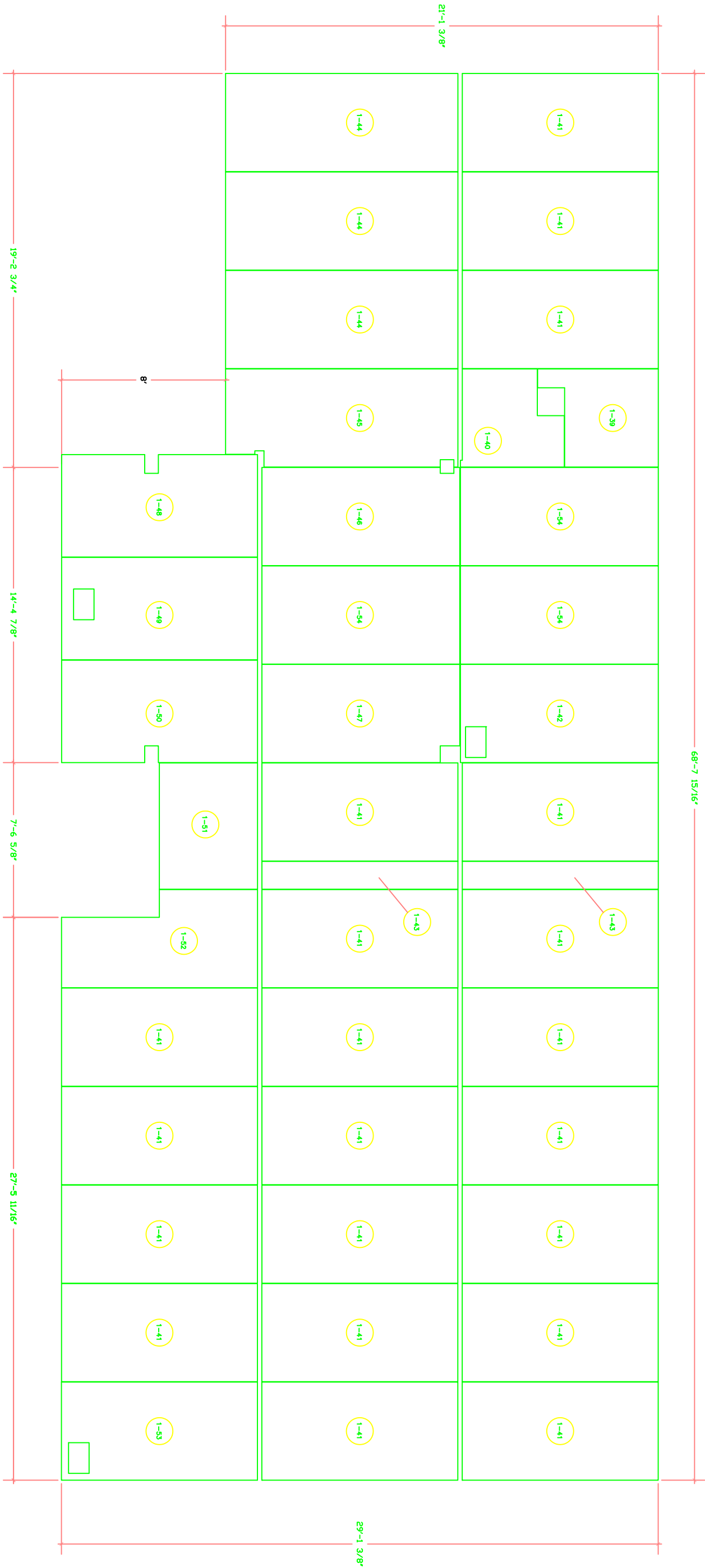

1 CEILING PANEL PLAN
SCALE: 3/8" = 1'-0"

JAWS 1

NO. DATE DESCRIPTION REVISIONS	MODULINE CEILING PLAN OLYMPIC STUDIOS	NATIONAL BROADCASTING COMPANY, INC. OLYMPICS 3 Landmark Square, Suite 401 Stamford, CT 06901 203 964-8681 203 964-8686 Fax	INDUSTRIAL ACOUSTICS COMPANY THE STANDARD OF SILENCE 1180 Commerce Avenue Bronx, NY 10462 (718) 631-8000 (718) 663-1138 DRAWING NO. 9916-142-111 DRAWN BY: JOC JOB NO. 75-0644-01	GEIGER ENGINEERS GEIGER GOSSEN HAMILTON LIAO ENGINEERS, P.C. 2 Executive Boulevard, Suite 410 Suffern, NY 10901-4164 (914) 368-3330 FAX: (914) 368-3366 <small>This document and its reproductions are copyright by GEIGER ENGINEERS and may not be reproduced or used in any manner without prior written permission from GEIGER ENGINEERS. Copyright © Dale 1999</small>
	DATE: 5/23/99 SCALE: AS NOTED JOB NO. 75-0644 CADD NO. 9916-142-111 SHEET NO. IAC-111			

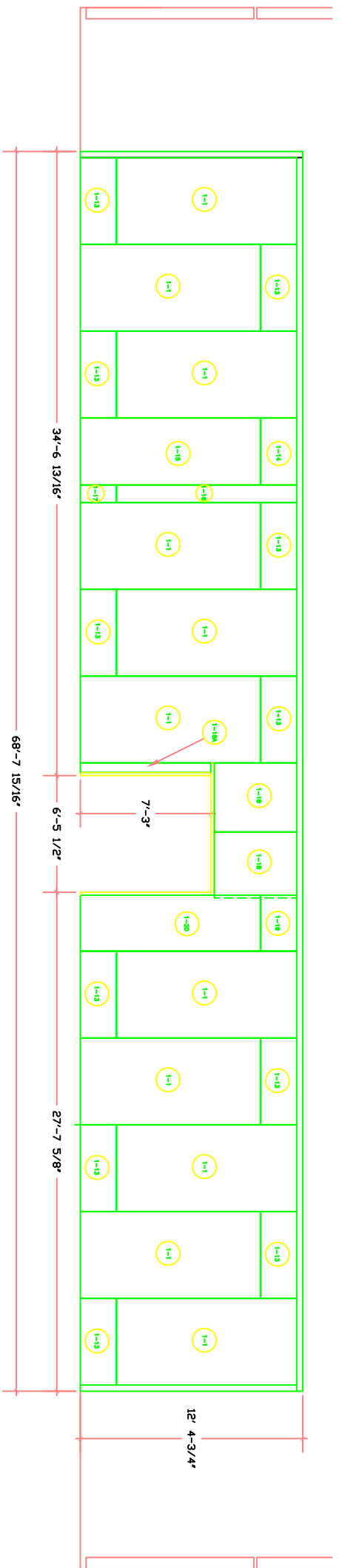

1 SECTION A
SCALE: 1/4" = 1'-0"



1 SECTION B
SCALE: 1/4" = 1'-0"

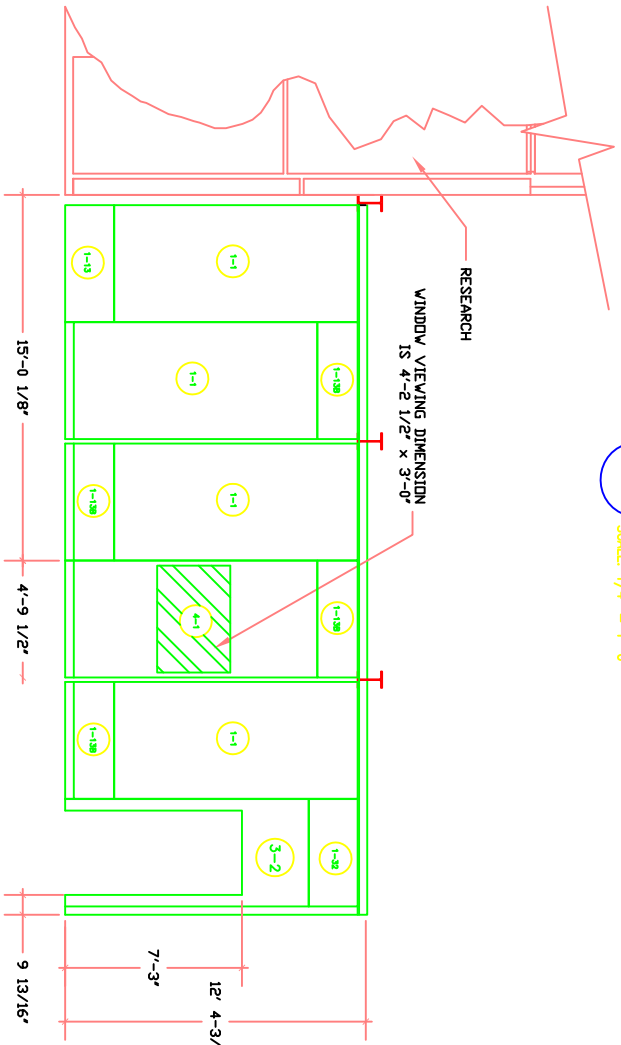

1 SECTION D
SCALE: 1/4" = 1'-0"

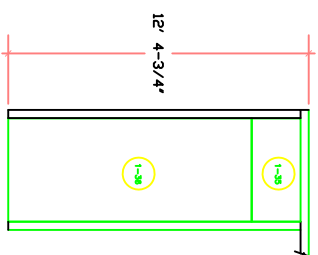

1 SECTION F
SCALE: 1/4" = 1'-0"

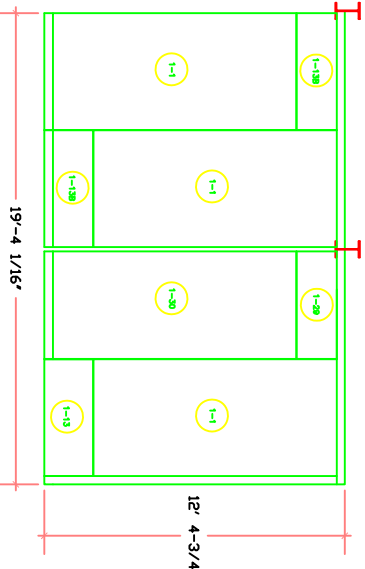

1 SECTION C
SCALE: 1/4" = 1'-0"

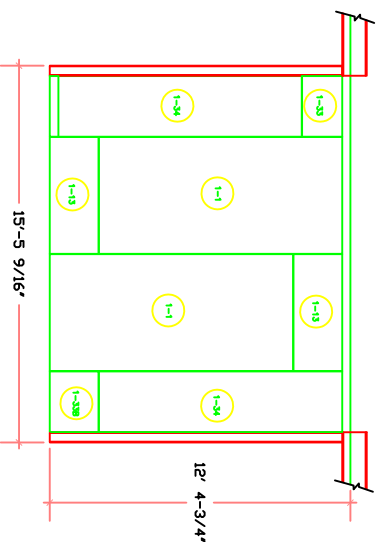

1 SECTION E
SCALE: 1/4" = 1'-0"

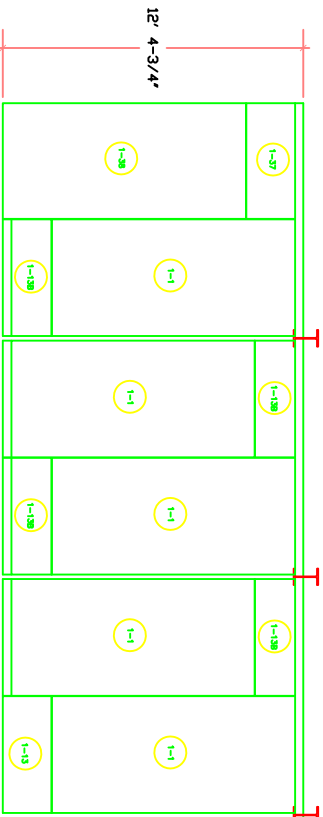

1 SECTION G
SCALE: 1/4" = 1'-0"

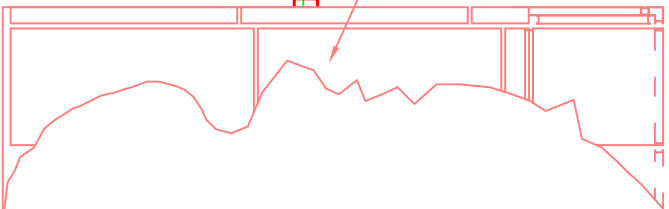

JAWS 1

GENERAL NOTES

1. PANEL CONSTRUCTION:

Noiselock III, as tested
Interior room sheet: 22ga galvalume perforated
Exterior room sheet: 14ga galvalume solid
Design weight: 10 lbs/sq. ft.
Panel fill is inert, mildew resistant and vermin proof
Fill is set back from perfl. with a wire mesh

2. DOOR SCHEDULE:

UNIT	LOCATION	SIZE	LEAVES	HAND
Studio 1	Main Entry	Existing Door	2 Plus Transom	-
	Rear Exit	3'-0" x 7'-0"	Single	Right
Control A	Main Entry	6'-0" x 7'-0"	Double	Open In
	Main Entry	3'-0" x 7'-0"	Single	Left
Sports Desk	Main Entry	6'-0" x 7'-0"	Double	Open In
	Main Entry	10'-0" x 8'-5"	Double	Open Out
Research	(near sports desk) Side Door	3'-0" x 7'-0"	Single	Right
	Rear Exit	3'-0" x 7'-0"	Single	Right
	Main Entry	Existing Door	2 Plus Transom	Right
Studio 2	Main Entry	3'-0" x 7'-0"	Single	Open In
	Rear Exit	6'-0" x 7'-0"	Double	Open In
Control B	Main Entry	6'-0" x 7'-0"	Double	Open In
	Main Entry	3'-0" x 7'-0"	Single	Left

3. WINDOWS:

(2) Noiselock Windows - "w" x "h"
Windows are double glazed, 3/16" thick safety glass. Each pane is mounted in an acoustically tight rubber molding. Window Panes are furnished with a desiccant material to prevent fogging.

4. STEEL:

All welds to be in accordance with standard commercial practices, per AWS D1.1
All columns, angles, and plates shall be ASTM A-36 grade steel
All steel and stud attached to trusses is by others

5. TOLERANCES:

Tolerance in accordance with standard commercial practices
Erection tolerance is +/- 1/8" to accommodate panel
It is the steel installers responsibility to ensure plumb and line installations

6. ELECTRICAL:

By Others

7. H.V.A.C.:

By Others

8. FINISH:

Exterior / Interior flat black baked on enamel

9. Please review these drawings carefully.

Approval of these drawings "as is" or "as noted" shall be the basis for release and fabrication

10. Request instruction for label:

Customer to provide color and tag specifications

11. For additional construction details please refer to GEIGER drawings

12. All dimensions are Imperial unless otherwise noted

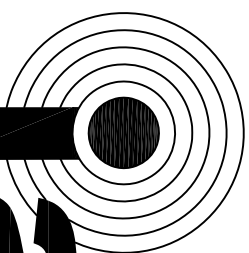

IAC

THE STANDARD OF SILENCE

INDUSTRIAL ACOUSTICS COMPANY
1160 Commerce Avenue • Bronx, NY 10462

J.A.W.S., 2

THESE 200 SERIES DRAWINGS ARE FOR JAWS 2.
(STUDIO 2, CONTROL B AND AUDIO B)

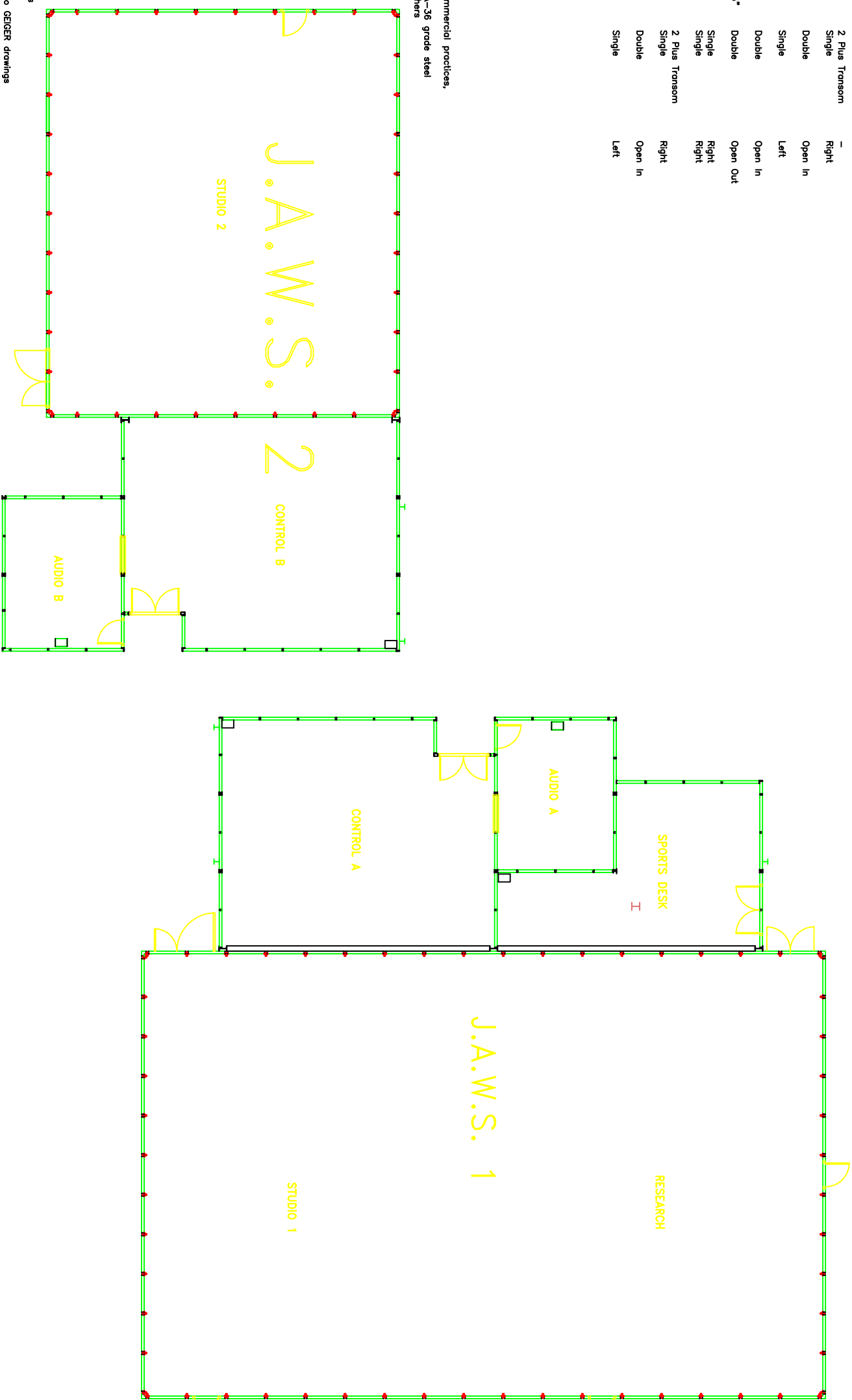

DWG. No.	TITLE
IAc - 201	IAc COLUMN LAYOUT
IAc - 202	CEILING PANEL PLAN
IAc - 203	ELEVATIONS - 1
IAc - 204	ELEVATIONS - 2
IAc - 205	DETAILS - 1
IAc - 206 A	DETAILS - 2 A
IAc - 206 B	DETAILS - 2 B
IAc - 206 C	DETAILS - 2 C
IAc - 206 D	DETAILS - 2 D
IAc - 206 E	DETAILS - 2 E
IAc - 207 A	DETAILS - 3 A
IAc - 207 B	DETAILS - 3 B
IAc - 208	DETAILS - 4
IAc - 209	NOT USED
IAc - 210	MODULE WALL PLAN
IAc - 211	MODULE CEILING PLAN
IAc - 212	MODULE ELEVATIONS
IAc - 213	NOT USED
IAc - 214	DETAILS - 7
IAc - 215	DETAILS - 8
IAc - 216	NOT USED
IAc - 217	COVER PLATES
IAc - 218	COVER PLATES
IAc - 219	COVER PLATES

<p>NATIONAL BROADCASTING COMPANY, INC. OLYMPICS 3 Landmark Square, Suite 401 Stamford, CT 06901 203 964-8681 203 964-8686 Fax</p>		<p>INDUSTRIAL ACOUSTICS COMPANY THE STANDARD OF SILENCE (718) 851-8000 9916-142-0</p>		<p>GEIGER ENGINEERS GEIGER GOSSEN HAMILTON LIAO ENGINEERS, P.C. 2 Executive Boulevard, Suite 410 Suffern, NY 10901-4164 914) 368-3330 Fax: (914) 368-3366</p>	
<p>TITLE PAGE OLYMPIC STUDIOS</p>		<p>DATE: _____ SCALE: _____ JOB NO. _____ CADD NO. _____ SHEET NO. _____</p>		<p>NO. DATE DESCRIPTION</p>	

